

BOOK

RECORDED IN BOOK 2 PAGE 96

State of Alabama
Lauderdale County
I, the undersigned, M. M. Barber, Civil Engineer of Florence, Ala.
hereby certify that the subdivision map herein is a true and
correct plat of that of Original Lots 285, 386 & 385 as shown
on map of Florence, Ala. made by Cypress Land Co.
that said plat shows a correct title government articles
Florence Ala. this the 15th day of May 1946.

M. M. Barber
Civil Engineer

State of Alabama
Lauderdale County
I, the undersigned, R. M. Martin, President of Florence Land &
Cotton Co. of the property shown or indicated on said plat
hereby accept said plat as an official record of same.
Florence Ala. this the 22nd day of May 1946

Florence Land Company
By *R. M. Martin*
President

State of Alabama
Lauderdale County
I, the undersigned, Florence C. Cotton, Secretary of the
said State and County hereby certify that said Martin who is
known to me, was acknowledged before me, that being informed of the
contents of the above certificate he signed the same voluntarily
as an act of Florence Land Co. on the day the same were there
Florence Ala. this the 22nd day of May 1946

Florence C. Cotton
Notary Public

State of Alabama
Lauderdale County
I, the undersigned, George R. Williams, Probate Judge of
said county hereby certify that the plat hereon was
filed for record in my office on this the 8th day of
May 1946 and is recorded in Plat Book No.
Page 46

George R. Williams
Probate Judge

Approved by City of Florence, Ala.
Board of Commissioners on this the
15th day of May 1946

M. M. Barber
Mayor

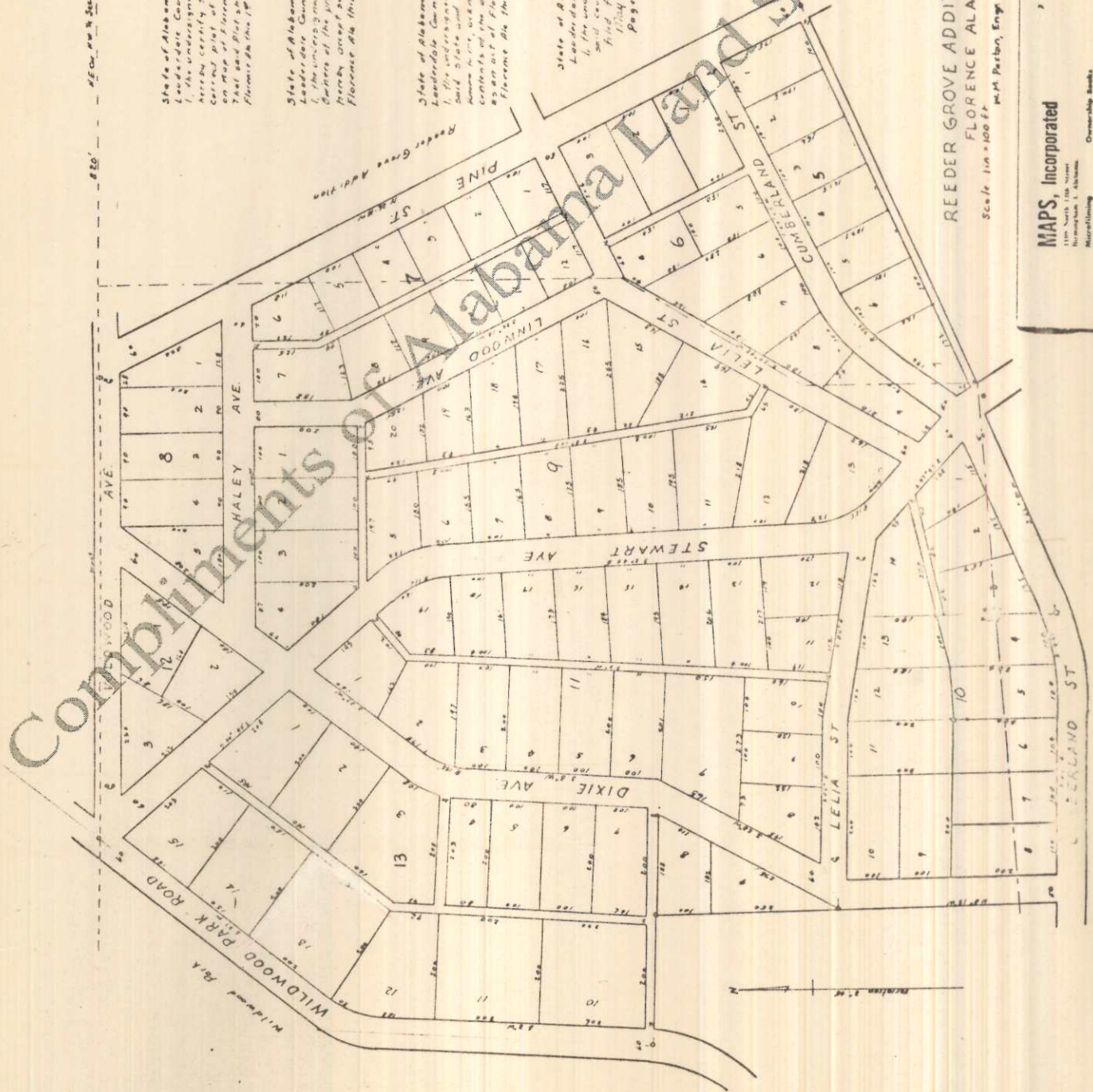

REEDER GROVE ADDITION NO 2
FLORENCE ALA
Scale 1 in = 100 ft
M. M. Barber, Eng

MAPS, Incorporated
1100 South 11th Street
Florence, Alabama

Compassing, Boundary
Aerial Photography
Tax Maps
Engineering
Drafting
Surveying
Plat Services

Compliments of Alabama Land Services