

RIVERBEND ADDITION

SCALE - 1" = 100'
FRANK G. CROW - ENGR.
JULY 1947

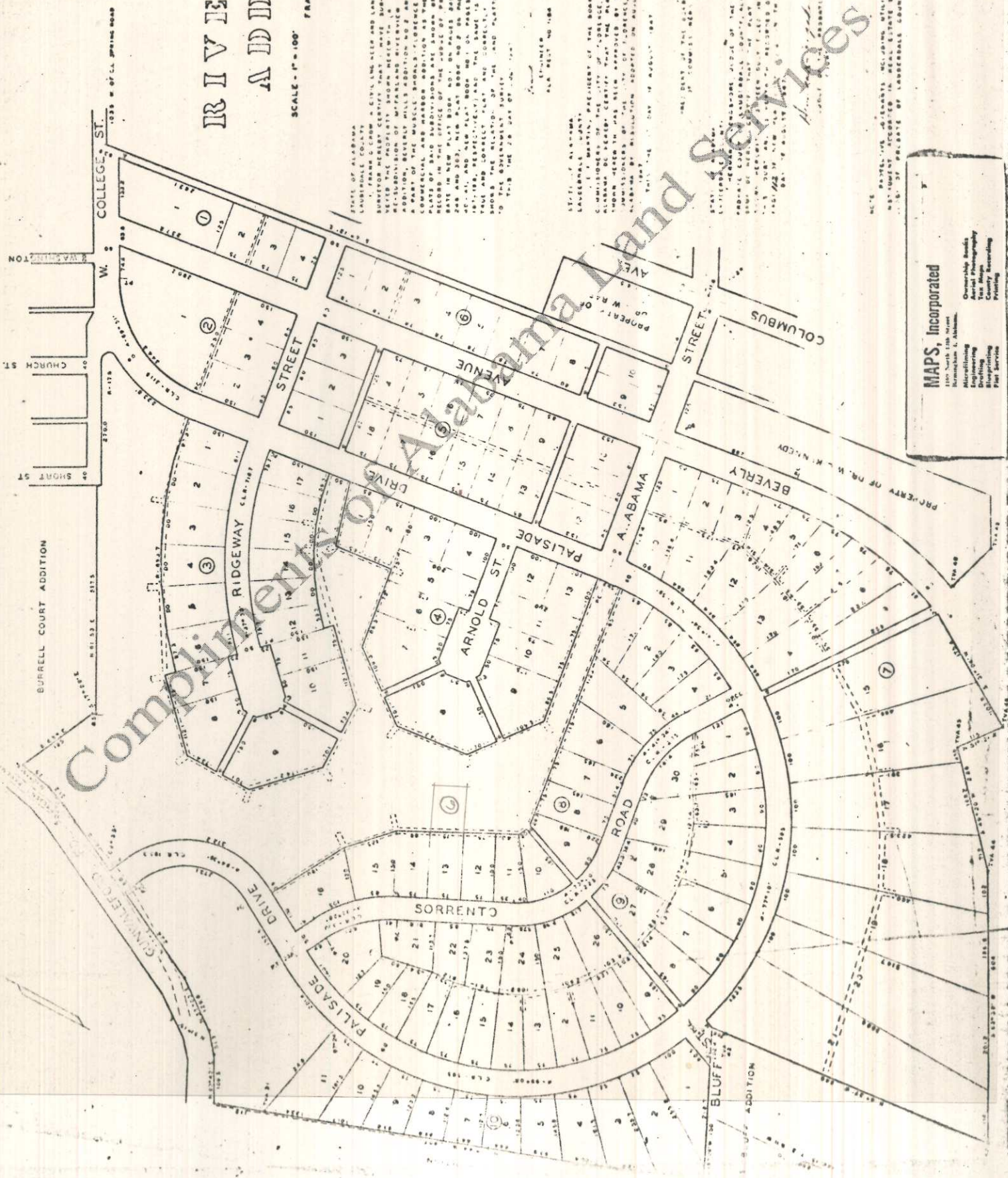

STATE OF ALABAMA
LAUDERDALE COUNTY
I, FRANK G. CROW, a Civil Engineer and Land Surveyor hereby certify that I have surveyed and subdivided the above described tract of land into lots and blocks as shown on the plat hereon attached, and that the same are in accordance with the laws of this State.
Witness my hand and the seal of my office this 28th day of July 1947.

STATE OF ALABAMA
LAUDERDALE COUNTY
I, W. W. WELLS, a Notary Public in and for the County of Lauderdale, do hereby certify that the above described tract of land was lawfully surveyed and subdivided into lots and blocks as shown on the plat hereon attached, and that the same are in accordance with the laws of this State.
Witness my hand and the seal of my office this 28th day of July 1947.

STATE OF ALABAMA
LAUDERDALE COUNTY
I, W. W. WELLS, a Notary Public in and for the County of Lauderdale, do hereby certify that the above described tract of land was lawfully surveyed and subdivided into lots and blocks as shown on the plat hereon attached, and that the same are in accordance with the laws of this State.
Witness my hand and the seal of my office this 28th day of July 1947.

NOTE: THESE PLATS, INCLUDING ALL OTHER PLATS, ARE FILED IN A SEPARATE FILE UNDER THE NAME OF RIVERBEND ADDITION IN THE OFFICE OF THE CLERK OF THE COUNTY OF LAUDERDALE COUNTY, ALABAMA.

MAPS, Incorporated
110 North 15th Street
Birmingham 4, Alabama

- Surveying
- Microfilming
- Photography
- Drafting
- Blaspheming
- Printing
- Plot Service